

Flanged End Ball Valve



NO.	Part	Material
1	Body	GG25/GGG40
2	Ball	Stainless steel
3	Seat	PTFE
4	Washer	PTFE
5	Packing seal	PTFE
6	Packing gland	GGG40
7	Locating plate	Steel
8	Clamp ring	65Mn
9	Handle	Steel
10	Shaft	Stainless steel
11	Bolt	Steel
12	Nut	Steel
13	Bolt	Steel

DESCRIPTION

1. Working pressure: 1.0Mpa/1.6Mpa
2. Working temperature: -20°C ~ +120°C
3. Face to face according to
1"-4": DIN3202 F4
5"-8": DIN3202 F5
4. Flange according to EN1092-2, etc.
5. Testing: DIN3230, API598
6. Medium: Water, Oil, Gases etc.

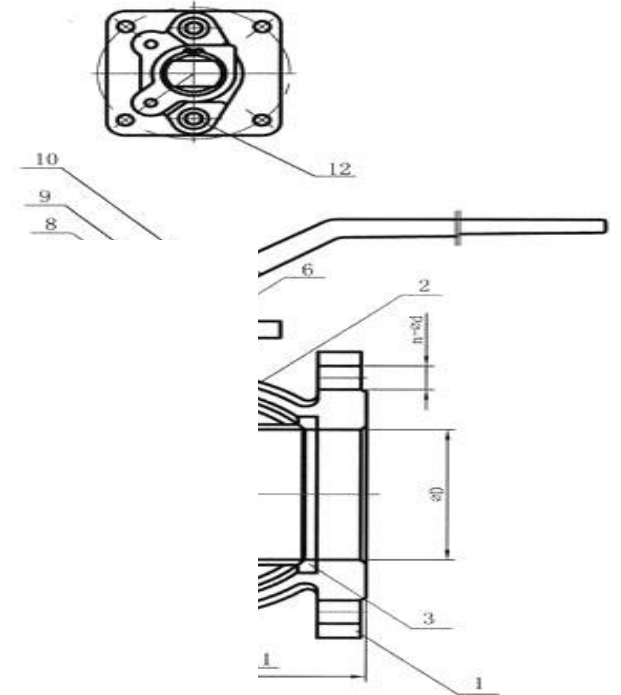

DN(mm)		1"	2"	2 1/2"	3"	4"	5"	6"	8"
L (mm)		125	150	170	180	190	325	350	400
ΦB(mm)		115	165	162	200	220	250	285	340
ΦD (mm)		25	50	65	80	100	125	150	200
ΦC(mm)		85	125	145	160	180	210	240	295
n-Φd(mm)	PN10	4-14	4-19	4-19	8-19	8-19	8-19	8-23	8-23
	PN16	4-14	4-19	4-19	8-19	8-19	8-19	8-23	12-23