

Double Disc Swing Check Valve (Normal pressure)

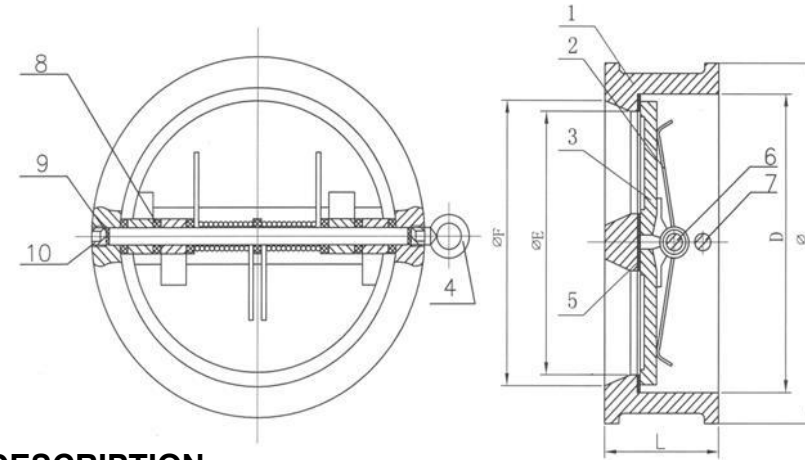

NO.	PART	MATERIAL
1	Body	GG25/GGG40/SS304/SS316
2	Spring	Stainless steel
3	Disc	SS316/SS304/WCB/C954
4	Ring	Steel
5	Seat Ring	NBR/EPDM/VITON
6	Shaft-1	SS316/SS304
7	Shaft-2	SS316/SS304
8	Gasket-1	PTFE
9	Gasket-2	NBR
10	Screw	Steel



DESCRIPTION

1. Working pressure: 1.0Mpa/1.6Mpa/2.5Mpa

2. Working temperature:

NBR: 0°C ~ +80°C

EPDM: -10°C ~ +120°C

VITON: -20°C ~ +180°C

3. Face to face according to DIN3202K3, ANSI 125/150

4. Flange according to EN1092-2, ANSI 125/150 etc.

5. Testing: DIN3230, API598.

6. Medium: Fresh Water, Sea water, food stuff, all kinds of oil, acid, alkaline liquid etc.

DN(mm)	40	50	65	80	100	125	150	200	250	300	350	400	450	500	600	700
L (mm)	43	43	46	64	64	70	76	89	114	114	127	140	152	154	178	229
D(mm)	65	65	80	94	117	145	170	224	265	312	360	410	450	500	624	720
Φ(m m)	PN10	92	107	127	142	162	192	218	273	328	378	438	489	532	585	690
	PN16	92	107	127	142	162	192	218	273	329	384	446	491	550	610	720