

3pcs Thread End Ball Valve



NO.	Part	Material
1	BODY	A216-WCB/A351-CF8/A351-CF8M
2	BALL	SS304/SS304/SS316
3	SEAT	PTFE
4	THRUST WASHER	PTFE
5	GASKET	PTFE
6	PACKING	PTFE
7	GLAND NUT	304
8	STEM	SS304/SS304/SS316
9	SPRING WASHER	304
10	NUT	304
11	HANDLE	304
12	LOCK	304
13	HANDLE COVER	PLASTIC
14	CAP	A216-WCB/A351-CF8/A351-CF8M
15	SPRING WASHER	304
16	NUT	304
17	BOLT	304

DESCRIPTION

1. Investment Casting for Body And Cap
2. Internal Entry Blow- Out Proof Stem
3. Pressure Rating: 1000PSI (PN63)
4. Treaded Ends: ANSI B2.1, BS 21, DIN 259/2999
5. Material: CF8M, CF8, CF3M, WCB
6. Pressure Test: API 598

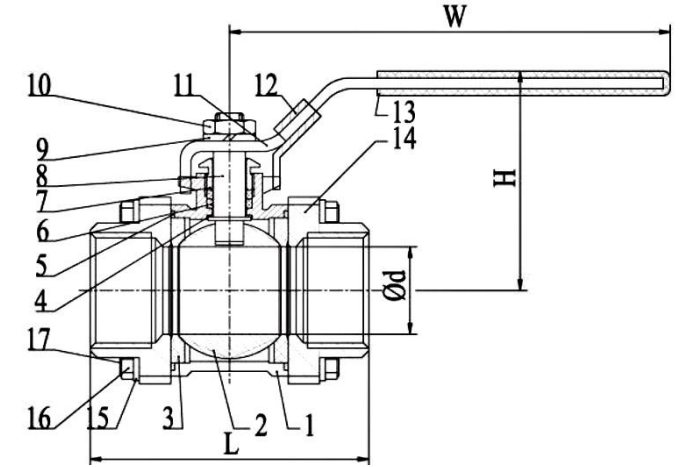

Size	d	L	H	W	N.W	KGS
1/4"	12.5	51	43.5	103	5	0.29
3/8"	12.5	51	44.5	103	5	0.29
1/2"	15	63	50	103	6	0.43
3/4"	20	71	59	127	10	0.61
1"	25	80	61	127	12	0.8
1-1/4"	32	94	79	154	17	1.43
1-1/2"	38	103	83	154	30	1.73
2"	50	126	94	195	48	2.72
2-1/2"	65	158	135	244	58	5.44
3"	80	179	144	244	96	7.64
4"	100	213	149	285	124	15.78