

2pcs Flanged End Ball Valve

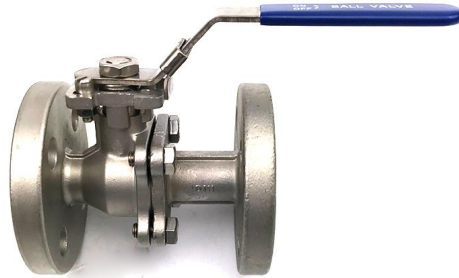

NO.	Part	Material
1	Body	CF8M
2	Cap	CF8M
3	Ball	SS316
4	Ball Seat	PTFE
5	Stem	SS316
6	Thrust Washer	PTFE
7	O-Ring	Viton
8	Stem Packing	PTFE
9	Glang	SS304
10	Washer	SS301
11	Nut	SS304
12	Washer	SS304
13	Stop Pin	SS304
14	Handle	SS304
15	Handle Cover	Plastic
16	Locking	SS304
17	Body Gasket	PTFE
18	Bolt	SS304

DESCRIPTION

1. Investment castings for Body and Cap
2. Internal Entry Blow-Out Proof Stem
3. Pressure Rating:PN16 PN25 PN40
4. Thread End: DIN3202 F4
5. Working pressure: -25°C+180°C
6. Material: CF8M,CF8,CF3M,WCB
7. Lock device (optional)

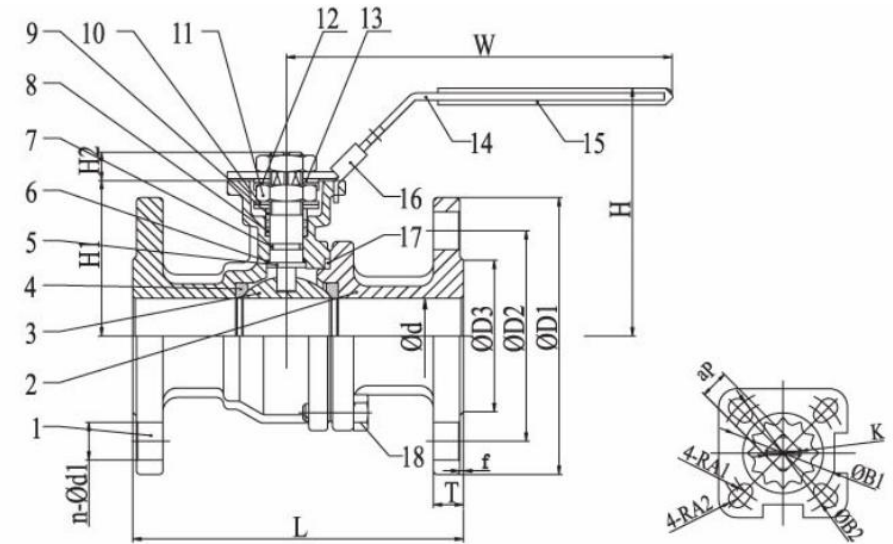

Size	d	L	T	f	D1	D2	D3	n-d1	H1	H	W	a`P	ISO5211	N.W	KGS
1/2"	15	115	16	2	95	65	45	4-14	48	82	120	9	F03/F04	5	2.91
3/4"	20	120	18	2	105	75	58	4-14	53	87	120	9	F03/F04	8	3.38
1"	25	125	18	2	115	85	68	4-14	58.5	90	160	11	F04/F05	10	3.73
1-1/4"	32	130	18	2	140	100	78	4-18	71	100	160	11	F04/F05	14	4.95
1-1/2"	40	140	18	3	150	110	88	4-18	76.5	105	200	14	F05/F07	18	6.10
2"	50	150	20	3	165	125	102	4-18	85	125	200	14	F05/F07	25	8.90
2-1/2"	65	170	18	3	185	145	122	4-18	100	142	255	17	F07/F10	48	12.80
3"	80	180	20	3	200	160	138	8-18	112.5	155	255	17	F07/F10	75	18.90
4"	100	190	20	3	220	180	158	8-18	125.5	168	300	17	F07/F10	110	26.60