

1pc Thread End Ball Valve



NO.	Part	Material
1	BODY	CF8M
2	CAP	CF8M
3	SEAT	PTFE
4	BALL	316
5	STEM	316
6	THRUST WASHER	PTFE
7	PACKING	PTFE
8	GLAND NUT	304
9	HANDLE	304
10	HANDLE COVER	PLASTIC
11	NUT	304
12	SPRING WASHER	304

DESCRIPTION

- 1) Investment Castings for Body and Cap
- 2) One piece design, floating ball valve, reduced bore
- 3) Pressure Rating; 1000PSI, PN63
- 4) Thread End: ANSI B2.1, BS21, ISO7/1
- 5) Working temperature: from -25 C to 180 C
- 6) Material: Stainless steel CF8M, CF8, 1.4408, 1.4403, WCB, CF3M
- 7) Flow medium: Water, Oil and Gas
- 8) Size from 1/4" to 2" Water, Sea Water, Inorganic acid and Alkaline Liquid etc.

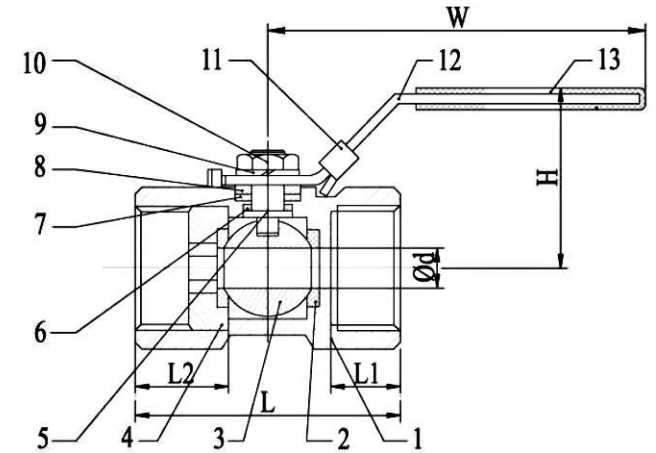

SIZE		d	L	H	W	N.M	KGS
DN6	1/4"	5	40	33	67	4	0.06
DN10	3/8"	7	44	36	67	4	0.08
DN15	1/2"	9	57	37	93	6	0.16
DN20	3/4"	12.5	59	42	93	6	0.26
DN25	1"	15	71	52	103	8	0.38
DN32	1-1/4"	20	78	56	103	10	0.65
DN40	1-1/2"	25	82	65	125	14	0.86
DN50	2"	32	100	70	125	15	1.4